

706000 WITH LEVER

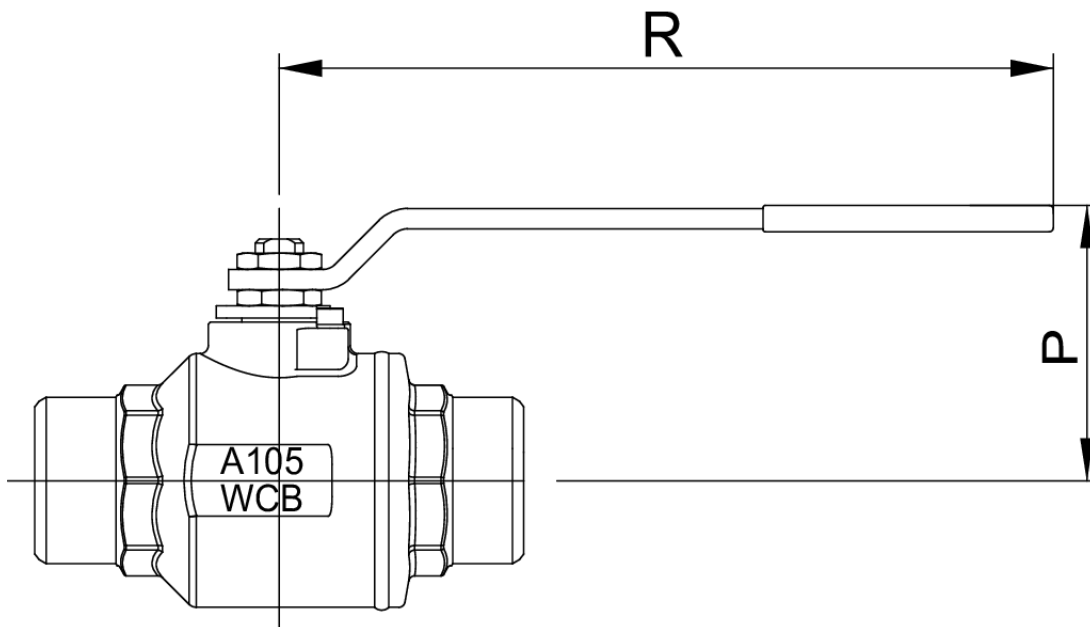

Fully welded floating ball valve for natural gas service, according to UNI 9734 and EN 13774, elongated stem for installation underground level, in ASTM A105, BW ends with handle.

Technical specifications



SIZE	DN	CODE	P	R
1"	25	70600006	83,5	174
1"1/4	32	70600007	86	174
1"1/2	40	70600008	106	250
2"	50	70600010	116,5	250
2"1/2	65	70600012	135,5	381
3"	80	70600014	146,5	381
4"	100	70600018	165	381

Epoxy painting 100 micron thick.

