

## 700056



Full bore blued carbon steel A352-LCB ball valve with  
AISI 304 ball and stem, F/F threading, ISO 5211.

NPT B.1.20.1 F/F.

### V-Ball option



Low temperature design  
-40°C ON DEMAND

## Technical specifications

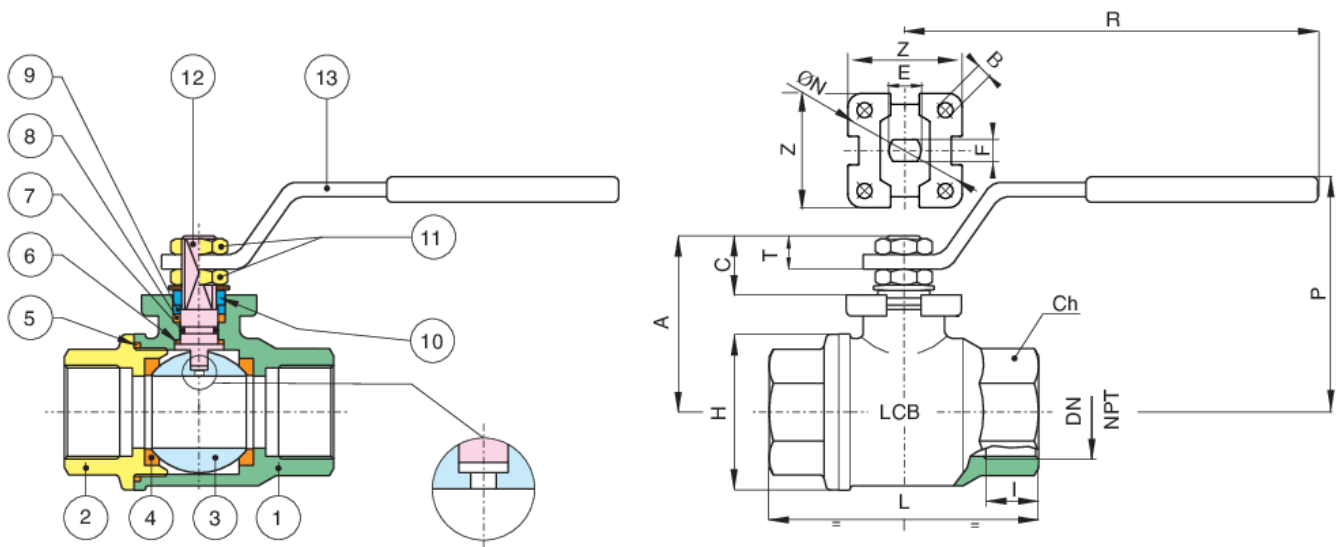

Temperature range: -20°C. +160°C.

Vacuum:  $10^{-2}$  torr.

| POSITION | PART NAME      | MATERIAL            | N.° PIECES |
|----------|----------------|---------------------|------------|
| 1        | BODY           | A352-LCB            | 1          |
| 2        | END CONNECTION | A352-LCB            | 1          |
| 3        | BALL           | A479-TP304/A351-CF8 | 1          |
| 4        | BALL SEAT      | PTFE                | 2          |
| 5        | BODY SEAT      | PTFE                | 1          |
| 6        | THRUST WASHER  | TFM                 | 1          |
| 7        | O-RING         | FKM (VITON)         | 1          |
| 8        | STEM SEAT      | PTFE                | 1          |
| 9        | PACKING GLAND  | A37+Z/P             | 1          |
| 10       | END STOP       | INOX AISI 430       | 1          |
| 11       | NUT            | 6S+Z/P              | 2          |
| 12       | STEM           | A479-TP304          | 1          |
| 13       | HANDLE         | A37+Z/P             | 1          |

| SIZE  | DN | CODE     | BOX | I    | L   | H  | CH    | R   | P   | A    | C    | T    | E  | F  | ØN ISO 5211 | B   | Z  | KV    | PN | KG   |
|-------|----|----------|-----|------|-----|----|-------|-----|-----|------|------|------|----|----|-------------|-----|----|-------|----|------|
| 1/4"  | 8  | 70005602 | 10  | 11   | 55  | 30 | ES.22 | 110 | 50  | 35   | 13,5 | 8    | 8  | 5  | 36          | 5,5 | 36 | 5,5   | 64 | 0,27 |
| 3/8"  | 10 | 70005603 | 10  | 11,4 | 55  | 30 | ES.22 | 110 | 50  | 35   | 13,5 | 8    | 8  | 5  | 36          | 5,5 | 36 | 8,5   | 64 | 0,26 |
| 1/2"  | 15 | 70005604 | 10  | 15   | 66  | 36 | ES.27 | 110 | 53  | 38   | 13,5 | 8    | 8  | 5  | 36          | 5,5 | 36 | 19,2  | 64 | 0,35 |
| 3/4"  | 20 | 70005605 | 5   | 16,3 | 79  | 45 | ES.32 | 131 | 68  | 51   | 15   | 10   | 10 | 7  | 42          | 5,5 | 42 | 35    | 64 | 0,65 |
| 1"    | 25 | 70005606 | 6   | 19,1 | 93  | 54 | OT.41 | 174 | 79  | 60   | 19,5 | 12,5 | 12 | 8  | 42          | 5,5 | 42 | 64,5  | 64 | 1,02 |
| 1"1/4 | 32 | 70005607 | 2   | 21,4 | 100 | 64 | OT.50 | 174 | 83  | 64,5 | 19,5 | 12,5 | 12 | 8  | 42          | 5,5 | 42 | 103,8 | 64 | 1,40 |
| 1"1/2 | 40 | 70005608 | 2   | 21,4 | 110 | 80 | OT.55 | 250 | 100 | 79   | 24   | 16,5 | 16 | 10 | 50          | 6,5 | 50 | 174   | 64 | 2,35 |
| 2"    | 50 | 70005610 | 2   | 25,7 | 131 | 95 | OT.70 | 250 | 107 | 86   | 24   | 16,5 | 16 | 10 | 50          | 6,5 | 50 | 301,3 | 64 | 3,54 |

## Certifications

SIL 3

SIL 3



TUV



ATEX FIRE-SAFE (On request)