

## 68F400 CARBON STEEL

Flansch-Kugelhahn ANSI 600 API STANDARD 608 aus C-Stahl A352-LCC verzinkt voller Durchgang, Baulänge nach ASME B16.10, Fire Safe und antistatische Ausführung, Blockier-Vorrichtung.

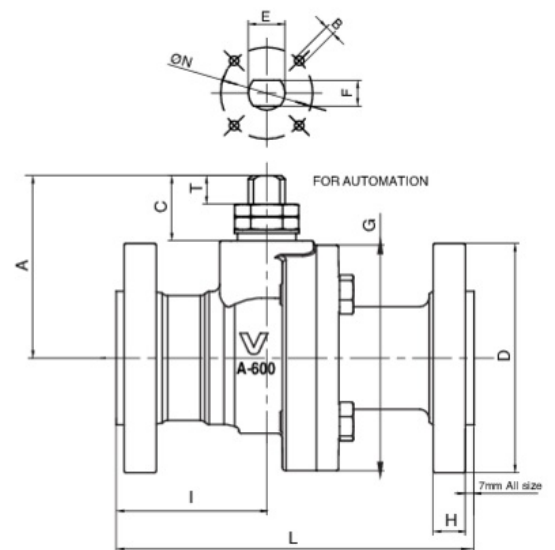

### Technische Spezifikationen

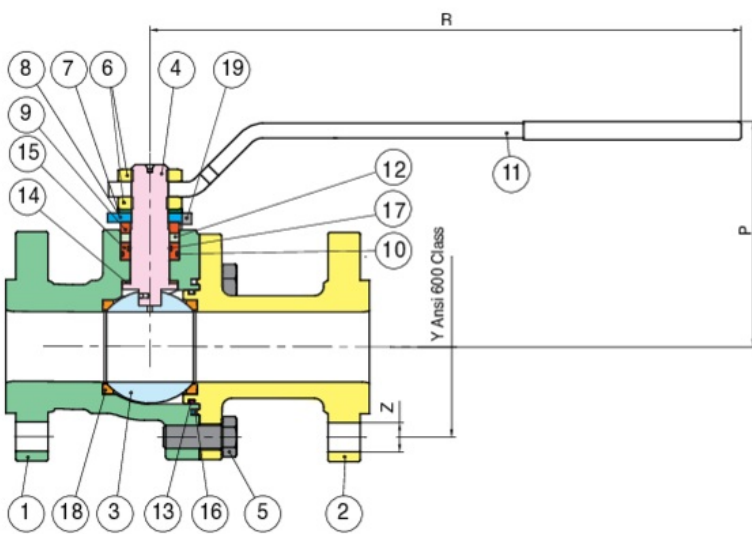

Temperature range:  $-20^{\circ}\text{C}$   $+180^{\circ}\text{C}$ .

Vacuum:  $10^{-3}$  torr.

| POSITION | TEILNAME            | MATERIAL     | NR. STÜCK |
|----------|---------------------|--------------|-----------|
| 1        | GEHÄUSE             | A352-LCC     | 1         |
| 2        | FLANSCH             | A352-LCC     | 1         |
| 3        | KUGEL               | A479-TP316   | 1         |
| 4        | SPINDEL             | 17-4-PH      | 1         |
| 5        | SCHRAUBE            | A320 L7      | 4-6       |
| 6        | MUTTER              | CARBON STEEL | 2         |
| 7        | TELLERFEDER         | CARBON STEEL | 2         |
| 8        | 90° STOP            | AISI 316     | 1         |
| 9        | BUCHSE              | A479-TP316L  | 1         |
| 10       | O-RING              | FKM          | 1         |
| 11       | HANDHEBEL           | CARBON STEEL | 1         |
| 12       | SPINDELDICHTUNG     | GRAFITE      | 1         |
| 13       | O-RING              | FKM          | 1         |
| 14       | SPINDELSCHEIBE      | RPTFE        | 1         |
| 15       | BUCHSE              | A479-TP316L  | 1         |
| 16       | GEHÄUSE ABDICHTUNG  | GRAFITE      | 1         |
| 17       | O-RING              | FKM          | 1         |
| 18       | SITZE KUGELDICHTUNG | RPTFE        | 2         |
| 19       | SCHRAUBE            | CARBON STEEL | 2         |

| GRÖSSE | DN | CODE     | D   | Y     | Z     | H    | I     | L   | G   | P   | R   | A    | C    | T    | E   | F  | ØN     | B  | KV    | PN  | KG    |
|--------|----|----------|-----|-------|-------|------|-------|-----|-----|-----|-----|------|------|------|-----|----|--------|----|-------|-----|-------|
| 1/2"   | 15 | 68F40004 | 95  | 66,7  | 4xØ16 | 14,3 | 69    | 165 | 85  | 95  | 174 | 54   | 21,5 | 6,8  | M12 | 8  | 42-F04 | M5 | 19,2  | 100 | 3,60  |
| 3/4"   | 20 | 68F40005 | 115 | 82,6  | 4xØ19 | 15,9 | 78,5  | 190 | 95  | 99  | 174 | 58   | 20,5 | 6,8  | M12 | 8  | 42-F04 | M5 | 35    | 100 | 5,10  |
| 1"     | 25 | 68F40006 | 125 | 88,9  | 4xØ19 | 17,5 | 97,5  | 216 | 105 | 100 | 250 | 75   | 29   | 10   | M16 | 10 | 50-F05 | M6 | 64,5  | 100 | 7,20  |
| 1"1/2  | 40 | 68F40008 | 155 | 114,3 | 4xØ22 | 22,3 | 130   | 241 | 128 | 123 | 321 | 99,7 | 35,5 | 15,5 | M20 | 14 | 50-F05 | M6 | 174   | 100 | 13,20 |
| 2"     | 50 | 68F40010 | 165 | 127   | 8xØ19 | 25,4 | 119,5 | 292 | 144 | 133 | 321 | 109  | 36,5 | 16,5 | M20 | 14 | 50-F05 | M6 | 301,3 | 100 | 17,40 |

## Zertifizierungen



TUV SIL 3



FIRE-SAFE Acc. EN ISO 10497/API 607



F.E. TESTED ISO15848-1

## Ersatzteile

### ● DICHTUNGEN

| Code   | Material                               | Größe |
|--------|--|-------|
| RI6115 | PTFE CARBOGRAFITE - CARBON FILLED PTFE | 15    |
| RI6116 | PTFE CARBOGRAFITE - CARBON FILLED PTFE | 20    |
| RI6117 | PTFE CARBOGRAFITE - CARBON FILLED PTFE | 25    |
| RI6118 | PTFE CARBOGRAFITE - CARBON FILLED PTFE | 40    |
| RI6119 | PTFE CARBOGRAFITE - CARBON FILLED PTFE | 50    |